

RoHS

| REV. | ECN NO. | LOCATIONS | DESCRIPTION | DATE | DESIGN |
|------|---------|-----------|-----------------------|------|--------|
| A0 | | | 原始版本(INITIAL EDITION) | | |

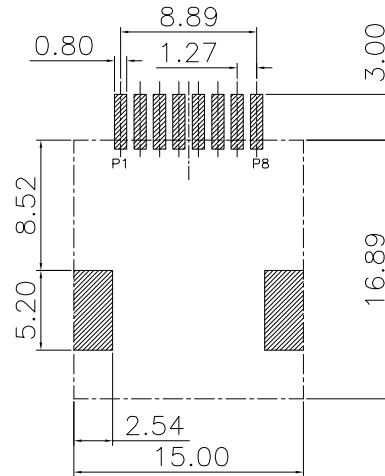
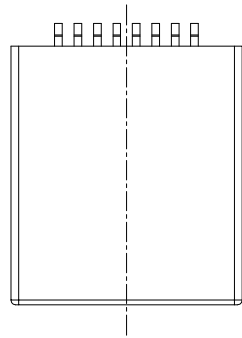

RECOMMENDED P.C.B LAYOUT
TOP VIEW (COMPONENT SIDE)

SPECIFICATION NOTES:

ELECTRICAL:

1. VOLTAGE RATING:150 VAC RMS
2. CURRENT RATING:1.5AMP
3. CONTACT RESISTANCE:30mΩ MAX
4. INSULATION RESISTANCE:500mΩ MIN AT 500V DC
5. DIELECTRIC STRENGTH:1500 V AC TO 1000 V AC RMS@ 0.5mA 50Hz TO 60Hz 1 MINUTE

MECHANICAL:

1. HOUSING/INSERT MATERIAL:THERMOPLASTIC, LCP UL94V-0 RATED,COLOR BLACK
2. CONTACT TERMINAL:Phosphor bronze T=0.30 PLATING NI30-50U", SN 100U"MIN. CONTENT AREA PLATED GOLD
3. SMT PIN MATERIAL:Copper Alloy T=0.40 PLATED NI30-50U", SN100U"MIN
4. OPERATING LIFE:750 CYCLES MIN.
5. MATING/UNMATING FORCE:30N MAX
6. RETENTION STRENGTH:50N FOR60S±5S.

ENVIRONMENTAL:

1. STORAGE:-40℃ TO +85℃ RELATIVE HUMIDITY<80%.
2. OPERATION:-40℃ TO +85℃

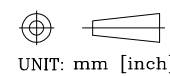
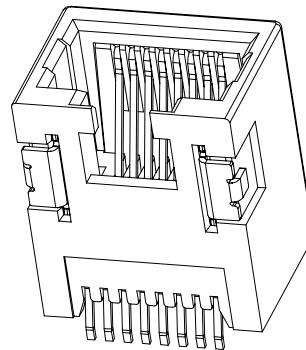
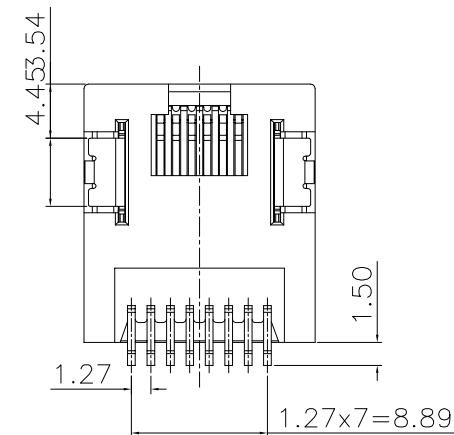
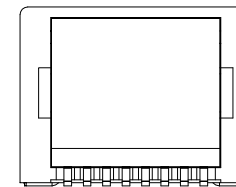
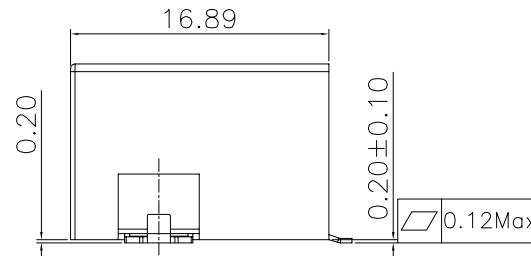
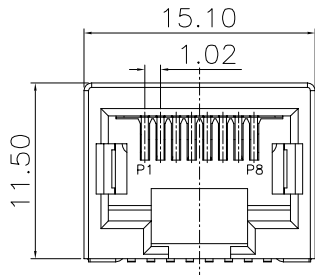

TOLERANCE:
 X.X ±0.35
 X.XX ±0.25
 X.XXX ±0.15
 Angle ±3.0°

SCALE:1:1 SIZE:A4



深圳市盈创利电子有限公司
 Shenzhen Ying Chuang Li Electronics co., LTD.

| | | |
|-----------|-----------------------------------|-----------|
| DESIGN: | PART NAME: RJ45 90度 SMT 1X1 全塑 | |
| CHECKED: | PART NO. | 5A27-297B |
| APPROVED: | DRAW NO. | |
| | SHEET NO. | 1 OF 1 |