

RoHS

REV.	ECN NO.	LOCATIONS	DESCRIPTION	DATE	DESIGN
A0			原始版本 (INITIAL EDITION)		

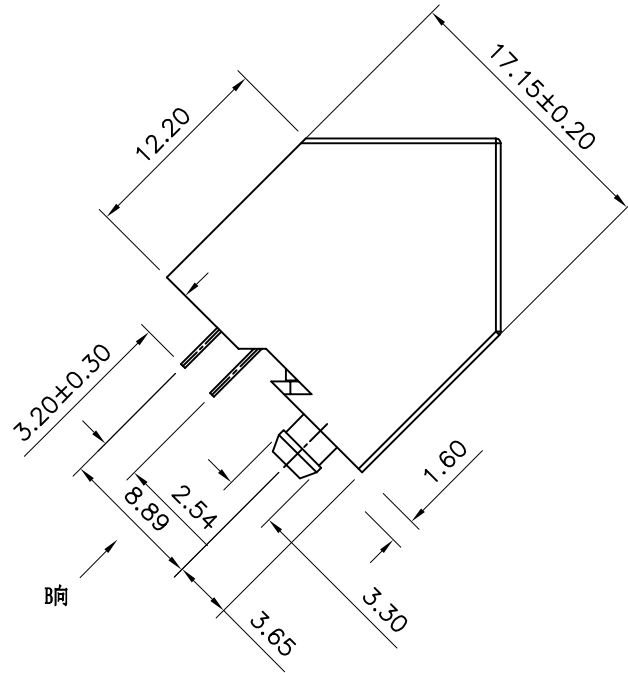
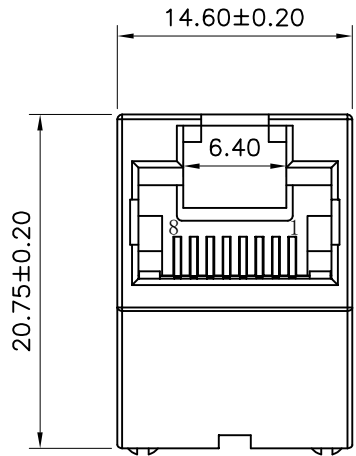

Notes:

1. Electrical:

1. Voltage Rating: 125VAC RMS.
2. Current Rating: 1.5AMP.
3. Contact Resistance: 20 MILLIOHMS MAX
4. Insulation Resistance: 1000 MEGOHMS MIN @500VDC
5. Dielectric Strength: 1000 VAC RMS 60Hz, 1Min

2. Mechanical:

1. Housing & Insert Material: PBT White UL94V-0
2. Contact Material: Copper Alloy T=0.35mm.
4. Plating: Nickel plating in the whole area 30U" min; Point of contact Gold plating G.F; Tin plating in solder area 80U" min.
5. Operating Life: 600 Cycles Min.

Environmental:

1. Storage: -40° — +85° C Relative Humidity < 70%.
2. Operation: -40° — +85° C.

RJ45 Pin definition:

Pin位	Name	Description
1	TX+	Tranceive Data+
2	TX-	Tranceive Data-
3	RX+	Receive Data+
4	N/C	Not connected
5	N/C	Not connected
6	RX-	Receive Data-
7	N/C	Not connected
8	N/C	Not connected

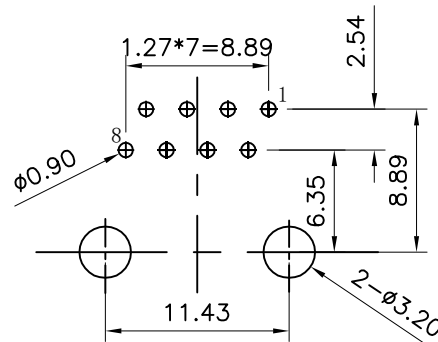
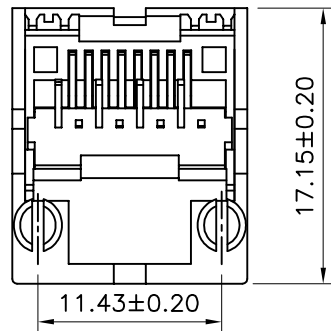

PCB Layout

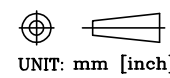

TOLERANCE:
 X.X ±0.35
 X.XX ±0.25
 X.XXX ±0.15
 Angle ±3.0°

SCALE:1:1 SIZE:A4



深圳市盈创利电子有限公司
 Shenzhen Ying Chuang Li Electronics co., LTD.

DESIGN:	PART NAME: RJ45 5226 全塑无灯 8P8C 扁针
CHECKED:	PART NO. 5A11-012A
APPROVED:	DRAW NO.
	SHEET NO. 1 OF 1

RoHS

REV.	ECN NO.	LOCATIONS	DESCRIPTION	DATE	DESIGN
A0			原始版本(INITIAL EDITION)		

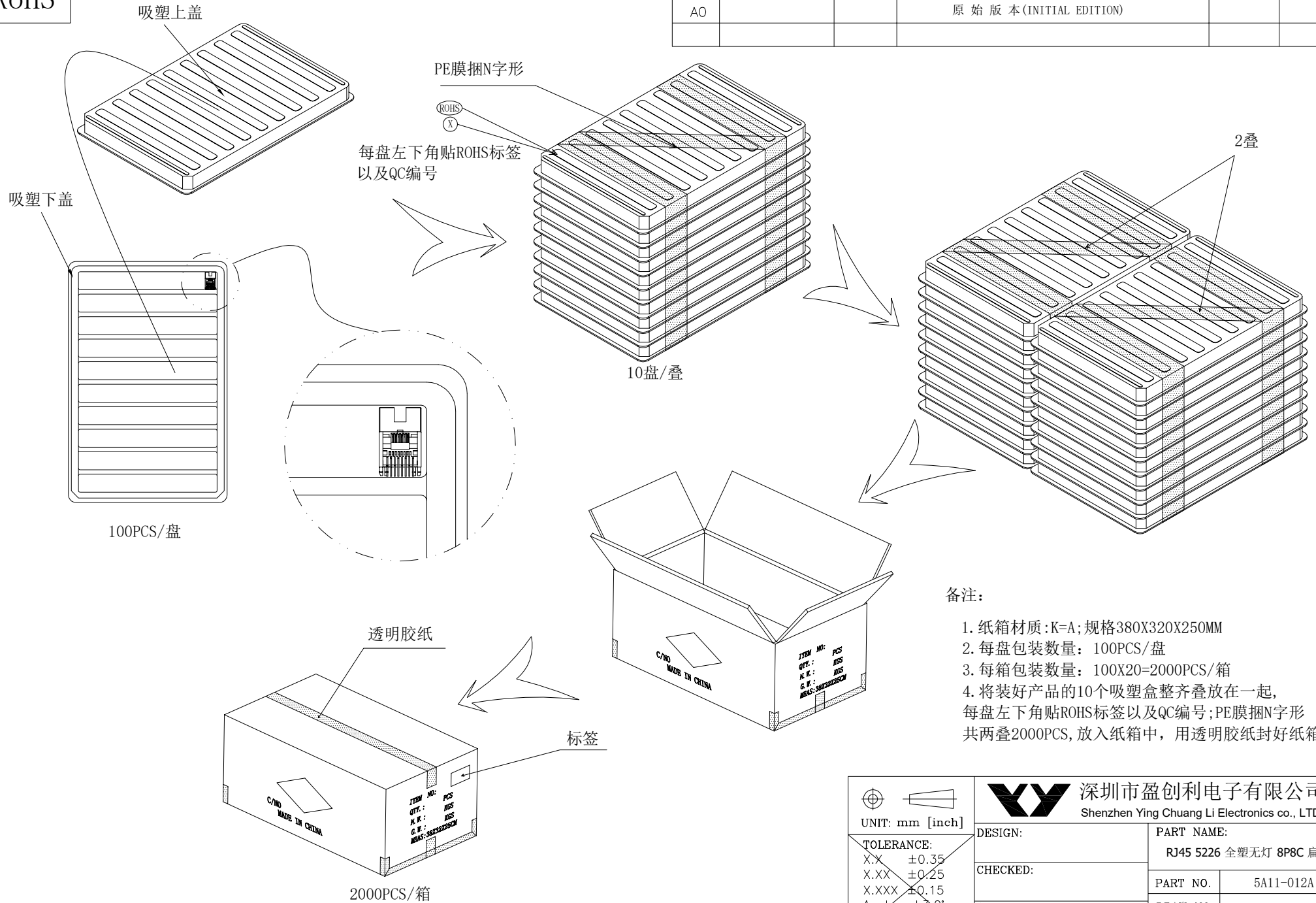

备注:

1. 纸箱材质:K=A;规格380X320X250MM
2. 每盘包装数量: 100PCS/盘
3. 每箱包装数量: 100X20=2000PCS/箱
4. 将装好产品的10个吸塑盒整齐叠放在一起,每盘左下角贴ROHS标签以及QC编号;PE膜捆N字形共两叠2000PCS,放入纸箱中,用透明胶纸封好纸箱。

<p>UNIT: mm [inch]</p> <p>TOLERANCE: X.X ±0.35 X.XX ±0.25 X.XXX ±0.15 Angle ±3.0'</p> <p>SCALE:1:1 SIZE:A4</p>	<p>深圳市盈创利电子有限公司 Shenzhen Ying Chuang Li Electronics co., LTD.</p>	
	DESIGN:	PART NAME: RJ45 5226 全塑无灯 8P8C 扁针
	CHECKED:	PART NO. 5A11-012A
	APPROVED:	DRAW NO.
		SHEET NO. 1 OF 1